



S-CUBE Backward curved centrifugal box fans

These fans are designed for direct or ducted ventilation in any residential, commercial and industrial buildings application. Designed for easy installation, their main characteristics are high efficiency and low noise level, thanks to the backward curved impeller and to the acoustic construction with double skin and acoustically lined panels. Suitable for conveying clean or slightly dusty air with max. temperature up to 50°C in continuous service.

- Extruded aluminium frame
- Galvanized steel sheet profiles and removable double skin panels
- Acoustic panel lining
- Backward curved impeller
- B3 motor fitted
- Support brackets with holes for lifting and easy installation
- Three phase or single phase motor

Accessories for S-CUBE

- Weatherproof cover
- Rainproof discharge outlet with guard
- Anti-vibration supports

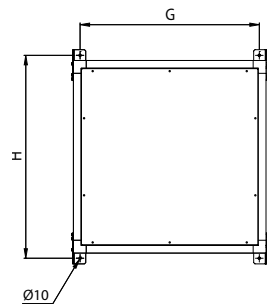
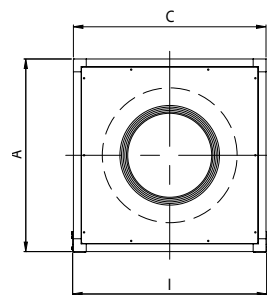

Standard Version

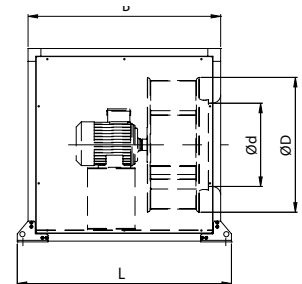

Round Spigot Version

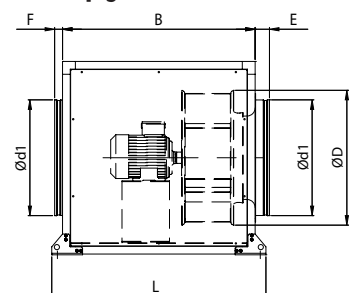

S-CUBE Standard Product Dimensions

Type	A	B	C	D	d	G	H	I	L	Weight [kg]
S-CUBE 25	500	500	500	260	180	468	530	506	565	30
S-CUBE 31	500	500	500	314	220	468	530	506	565	32
S-CUBE 35	640	640	640	384	270	605	667	643	700	48
S-CUBE 40	640	640	640	427	296	605	667	643	700	52
S-CUBE 45	750	750	750	468	296	698	790	756	835	82
S-CUBE 50	750	750	750	525	327	698	790	756	835	90
S-CUBE 56	1000	1000	1000	580	370	948	1040	1006	1085	135
S-CUBE 53	1000	1000	1000	652	430	948	1040	1006	1085	146

S-CUBE round Spigot Version Dimensions

Type	A	B	C	D	d1	E	F	G	H	I	L	Weight [kg]
S-CUBE 25	500	500	500	260	250	55	40	468	530	506	565	30
S-CUBE 31	500	500	500	314	315	55	40	468	530	506	565	32
S-CUBE 35	640	640	640	384	384	55	40	605	667	643	700	48
S-CUBE 40	640	640	640	427	427	55	40	605	667	643	700	52
S-CUBE 45	750	750	750	468	468	55	30	698	790	756	835	82
S-CUBE 50	750	750	750	525	525	55	30	698	790	756	835	90
S-CUBE 56	1000	1000	1000	580	580	75	50	948	1040	1006	1085	135
S-CUBE 53	1000	1000	1000	652	652	75	50	948	1040	1006	1085	146

S-CUBE 25 Product Range

Type	U	P	Pm [kW]	In [A]	IP/CL	Mot. [Gr]	Lp db[A]
S-CUBE 254	M	4	0.09	0.90	55/F	56	36
S-CUBE 254	T	4	0.09	0.38	55/F	56	36

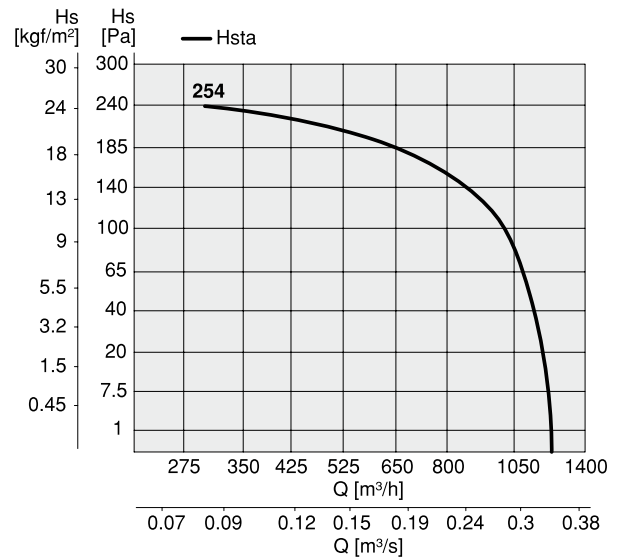

S-CUBE 31 Product Range

Type	U	P	Pm [kW]	In [A]	IP/CL	Mot. [Gr]	Lp db[A]
S-CUBE 314	M	4	0.12	1.20	55/F	63	44
S-CUBE 314	T	4	0.12	0.57	55/F	63	43

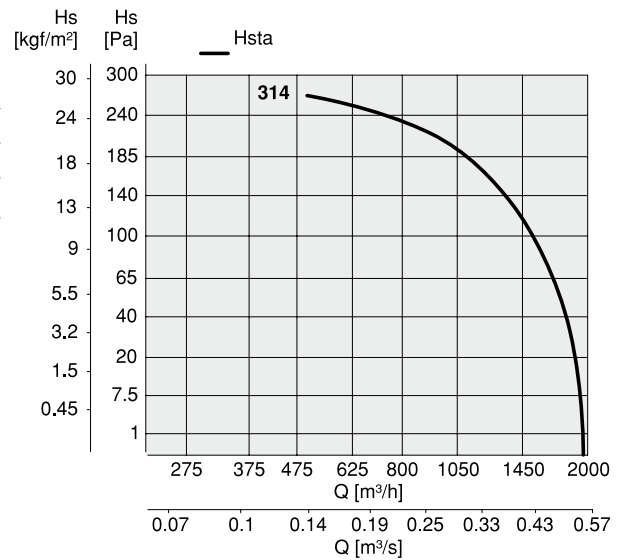

S-CUBE 35 Product Range

Type	U	P	Pm [kW]	In [A]	IP/CL	Mot. [Gr]	Lp db[A]
S-CUBE 354	M	4	0.25	2.35	55/F	71	43
S-CUBE 354	T	4	0.25	0.86	55/F	71	47

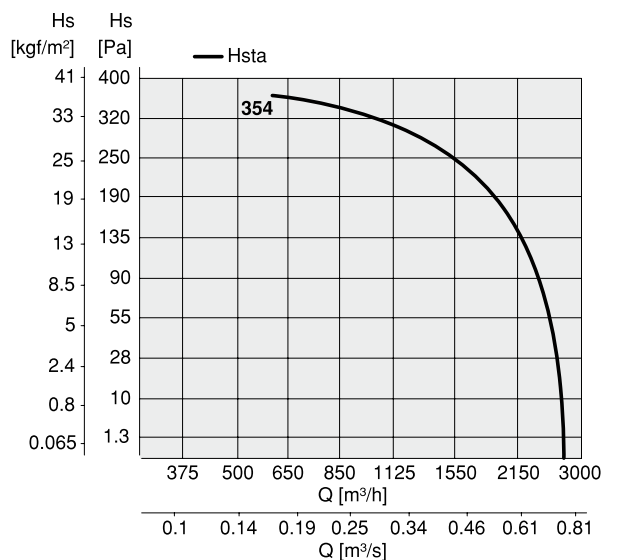

S-CUBE 40 Product Range

Type	U	P	Pm [kW]	In [A]	IP/CL	Mot. [Gr]	Lp db[A]
S-CUBE 404	M	4	0.55	4.75	55/F	80	49
S-CUBE 404	T	4	0.55	1.60	55/F	80	52

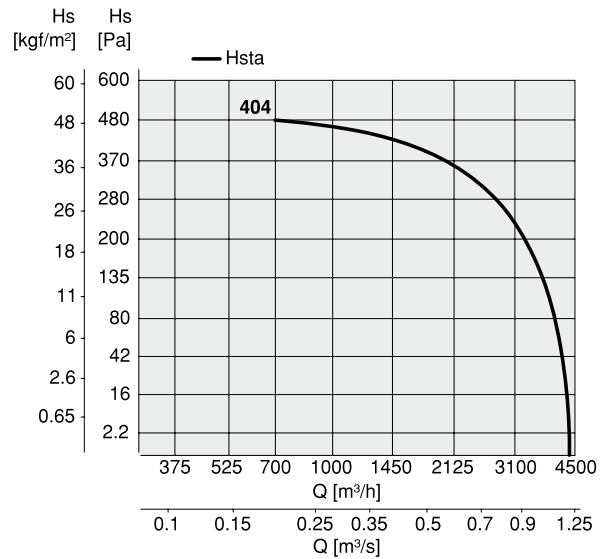

S-CUBE 45 Product Range

Type	U	P	Pm [kW]	In [A]	IP/CL	Mot. [Gr]	Lp db[A]
S-CUBE 454	M	4	0.75	5.60	55/F	80	51
S-CUBE 454	T	4	0.75	2.20	55/F	80	50
S-CUBE 454	T	6	0.37	1.20	55/F	80	41

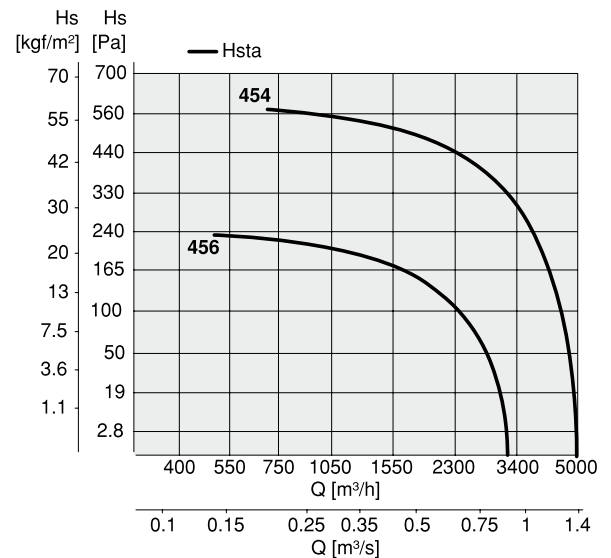

S-CUBE 50 Product Range

Type	U	P	Pm [kW]	In [A]	IP/CL	Mot. [Gr]	Lp db[A]
S-CUBE 504	T	4	1.10	2.80	55/F	90S	56
S-CUBE 504	T	6	0.37	1.20	55/F	80	45

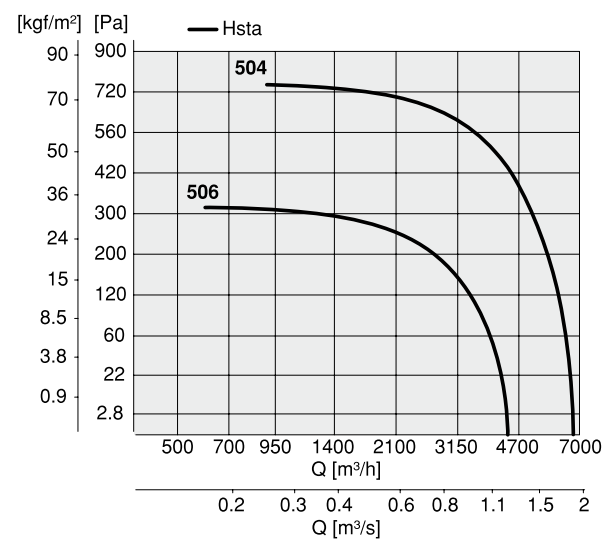

S-CUBE 56 Product Range

Type	U	P	Pm [kW]	In [A]	IP/CL	Mot. [Gr]	Lp db[A]
S-CUBE 566	T	6	0.55	1.80	55/F	89	47

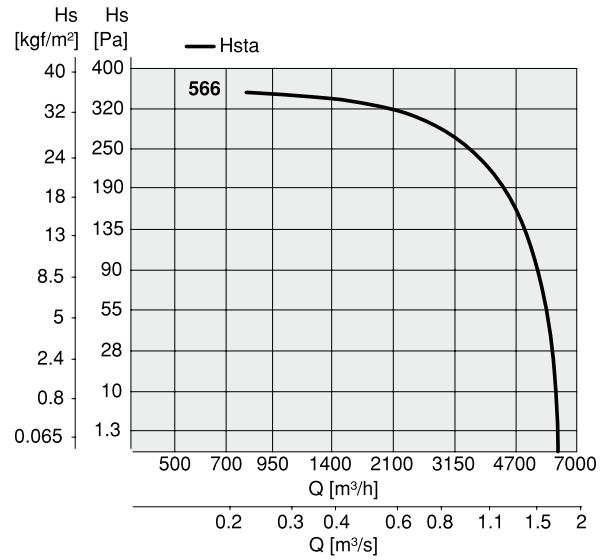

S-CUBE 63 Product Range

Type	U	P	Pm [kW]	In [A]	IP/CL	Mot. [Gr]	Lp db[A]
S-CUBE 636	T	6	1.10	3.40	55/F	90L	52

